

M3518FIC-MPIR

f=35mm F1.8 Day & Night
for 2/3 type 5 Megapixel Cameras, Fixed-focal, Manual Iris
C-Mount

Model No.	M3518FIC-MPIR		Effective	Front	φ 19.8mm		
Focal Length	35mm		Lens Aperture	Rear	φ 12.1mm		
Max. Aperture Ratio	1:1.8		Back Focal Length		14.3mm		
Max. Image Format	11.3mm x 6.0mm (φ 12.8mm)		Flange Back Length		17.526mm		
Operation Range	Iris	F1.8 - F16C		Mount	C-Mount		
	Focus	1m - Inf.		Filter Size	M40.5 × 0.5		
	Zoom	-		Dimensions	φ 46.5mm × 53.2mm		
Control	Iris	Manual		Weight	149.2g		
	Focus	Manual					
	Zoom	-					
Angle of View	D	2/3 type	17.4°	1/2 type	12.7°	1/3 type	9.5°
	H		13.9°		10.2°		7.6°
	V		10.5°		7.6°		5.7°
CMV2000 11.264 × 5.984 (φ 12.75)	D	20.0°					
	H	17.8°					
	V	9.5°					
Operating Temperature	-10°C - +50°C						

Dimensions

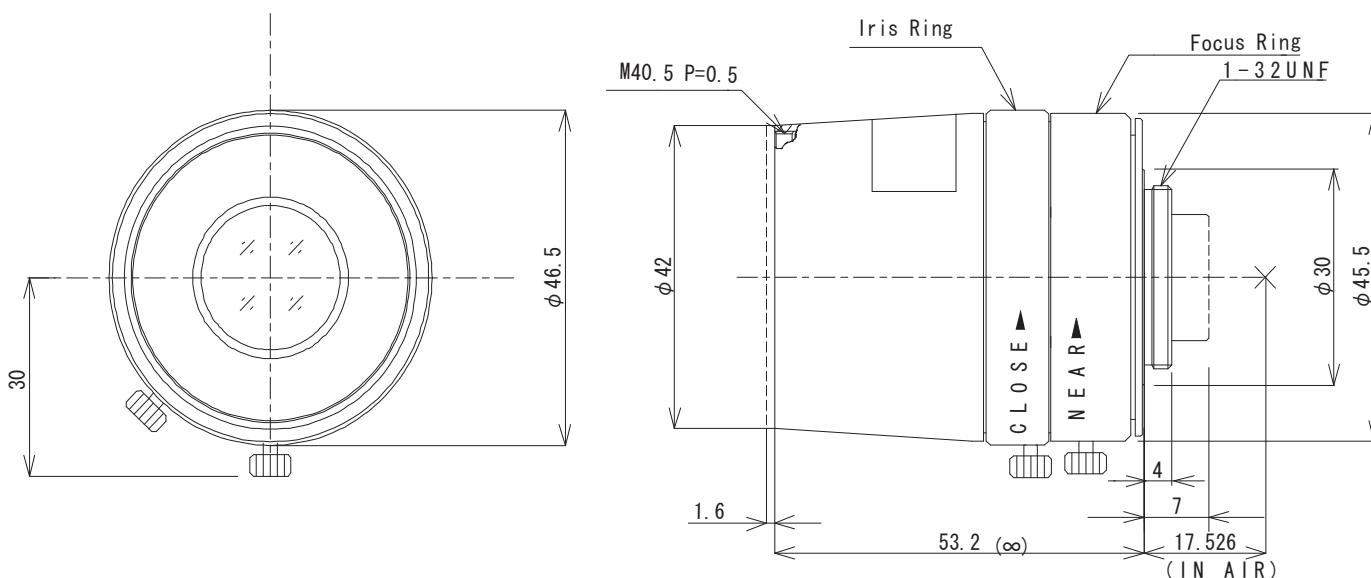

O-COMP39-06/2015 - Subject to technical change without notice. No liability is accepted for errors which may be contained in this document.