

LGATE-952 Universal Gateway

Installation instructions

Instructions de montage

Montageanweisung

Montagevoorschrift

Istruzioni di montaggio

Instrucciones de montaje

Monteringsanvisning

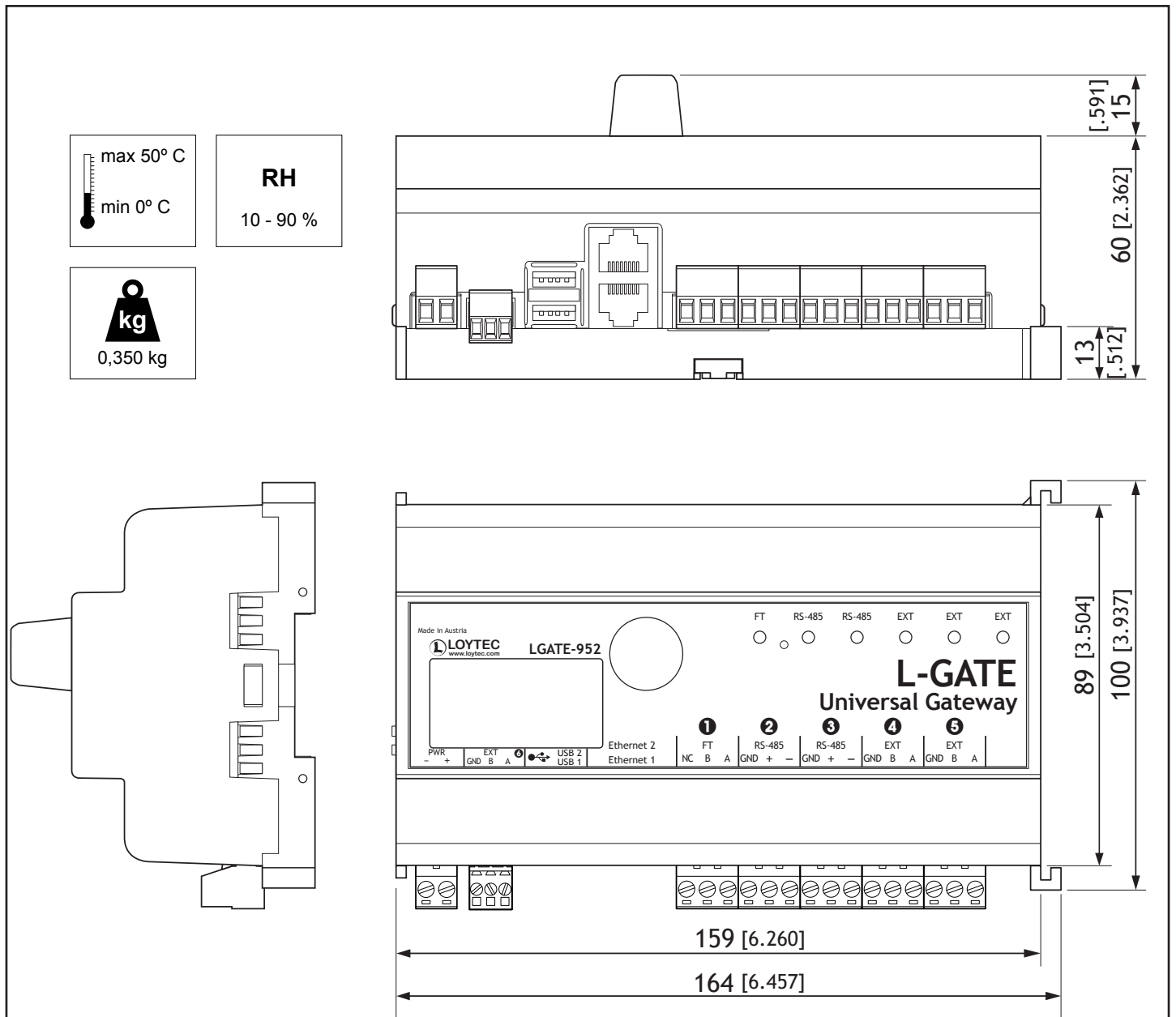

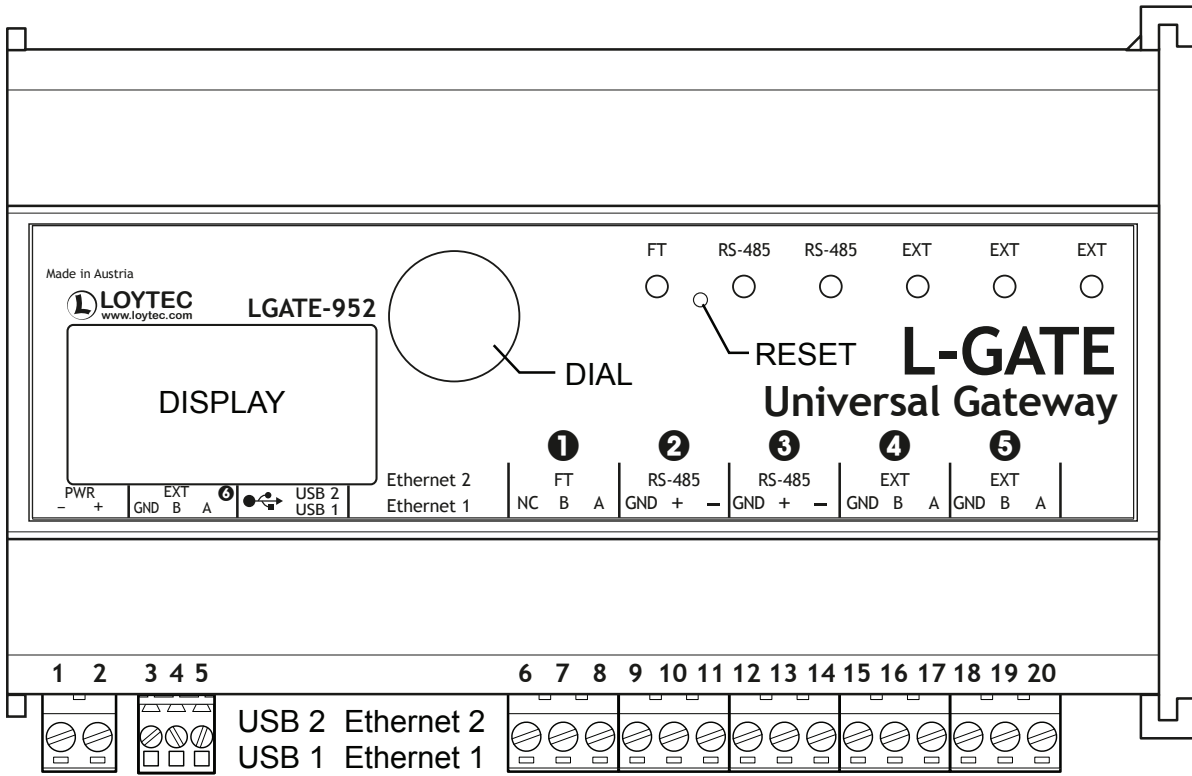

Connectors		
POWER	1	Power supply input -
	2	Power supply input +
Input + must NOT be connected to EARTH GND		
EXT PORT 6	3	GND
	4	B
	5	A
CEA-709 TP/FT-10 PORT 1	6	NC
	7	B
RS-485 PORT 2	8	A
	9	GND
RS-485 PORT 3	10	+
	11	-
	12	GND
EXT PORT 4	13	+
	14	-
	15	GND
EXT PORT 5	16	B
	17	A
	18	GND
	19	B
	20	A

Connectors		
USB1	USB-A	USB Device
USB2	USB-A	USB Device
USB	μ-USB	PC
Ethernet1	RJ45	10/100Base-T
Ethernet2	RJ45	10/100Base-T
Buttons		
RESET	Reset	
DIAL	Turn-and-Push Dial	

4.5 lb-in/0.5 Nm

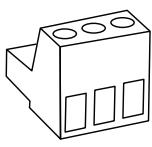

Weidmüller
 BLZP 5.08/03/180
 BLZP 5.08/02/180
 BL 3.50/03/180 SN OR BX

Weidmüller
 BL 5.08
 0.2 - 2.5 mm²

Weidmüller
 BL 3.5
 0.2 - 1.5 mm²

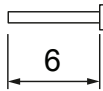
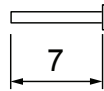

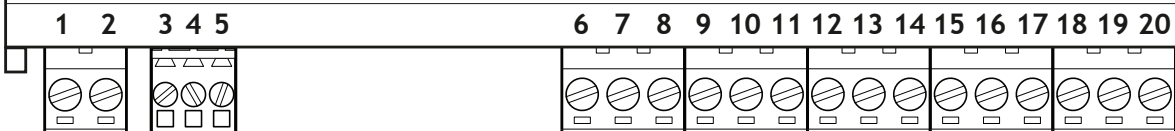
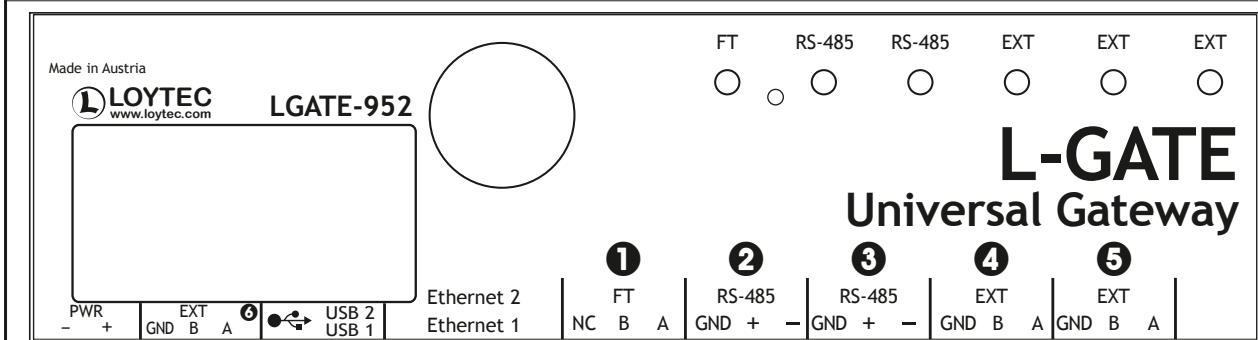

STATUS LEDs		
FT	GREEN flashing fast GREEN flashing 1 Hz RED permanent RED flashing fast	Traffic on CEA-709 port Not commissioned CEA-709 port damaged CEA-709 traffic overload
RS-485 MODBUS MS/TP	GREEN flashing RED flashing GREEN flashing fast ORANGE flicker RED permanent RED flashing fast	Modbus traffic Transmission errors Token ok, traffic Single master, traffic Token lost, cable damage Communication errors
EXT	GREEN GREEN flashing RED permanent RED flashing fast	M-Bus/KNX link M-Bus/KNX activity M-Bus/KNX port damaged M-Bus/KNX traffic overload

Please update the firmware of the device first,
 see www.loytec.com

DHCP enabled
 User: admin
 Password: loytec4u

35 mm x 7.5 mm DIN rail (EN 50022, BS 5584, DIN 46277-3)

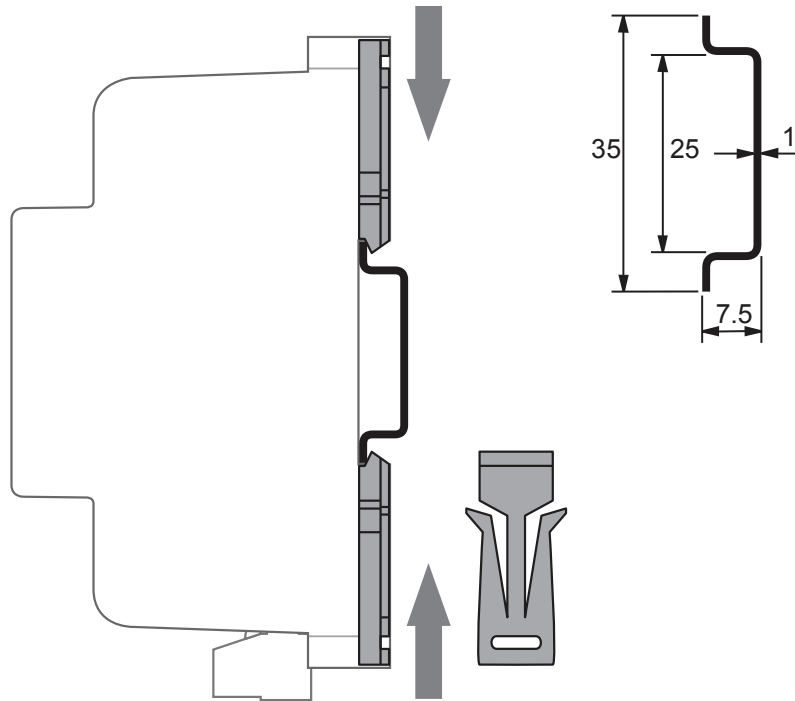

Node ID of CEA-709 Port 1

Virtual (Node) ID of CEA-852 port (Ethernet)

MAC address of CEA-852 Ethernet port

Serial number of the device

